

**Briton**

Door furniture &  
accessories

Product overview



## Briton door furniture & accessories

The first point of contact for anyone entering and moving around a building is the door hardware, whether that is a pull handle or a lever handle. In addition to having the right look, the hardware you select must have the right feel and finish and be backed up by a level of performance which will ensure the hardware is suited to the application and the amount of use or abuse it will have to endure.

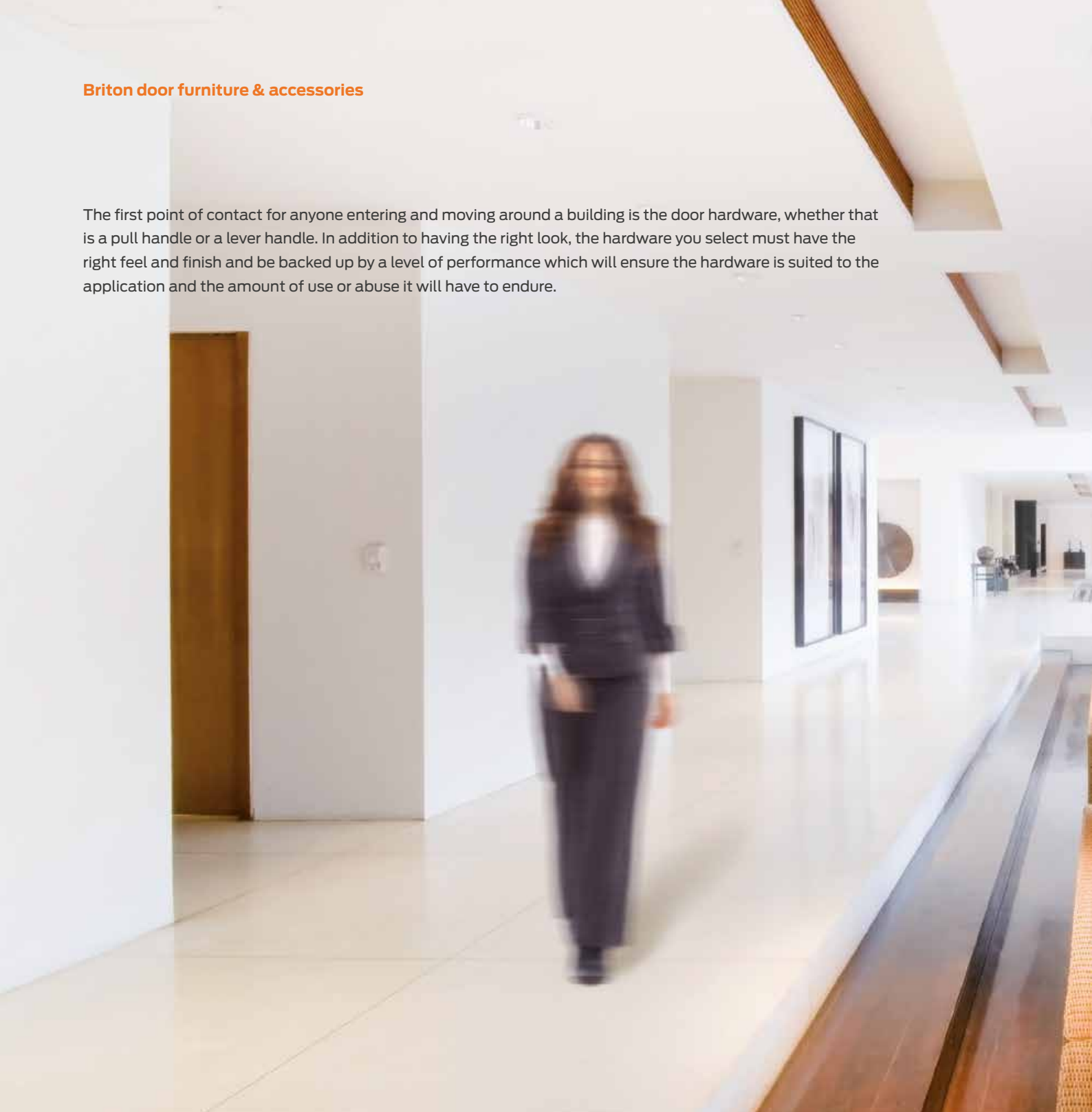

The latest Briton door furniture and accessories are a high performance range of designs suitable for any application, including the full hardware requirement of the majority of doorsets.

Fully compatible with all Briton cylinder lockcases and overhead door controls to provide a fully integrated hardware solution.

See pages 4 to 14





The Normbau branded range of hardware in steel cored or solid nylon offers a coloured alternative to stainless steel. The comprehensive range of fittings encompasses all the components required for a fully integrated doorset in a range of 10 colours.

Compatible with Briton door controls which are available in matching powder coated finishes.

See pages 15 to 27



# Quality starts with performance and durability

The first point of contact for anyone entering and moving around a building is the door hardware, whether that is a pull handle or a lever handle. In addition to having the right look, the hardware you select must have the right feel and finish and be backed up by a level of performance which will ensure the hardware is suited to the application and the amount of use it will have to endure.

The Briton Specification Series of door hardware is a high quality, high specification range of lever and pull handle door furniture in satin stainless steel. The range encompasses the complete hardware requirement of the large majority of doorsets.

Lever furniture features a unique fixing method which provides a firm, positive and highly durable installation. When combined with designs which meet the requirements of BS 8300, successful fire testing to 90 minutes on timber doors and 4 hours on steel doors and our 10 year warranty, Briton Specification Series hardware is ideally suited to new build or refurb installations which require a classical contemporary appeal.



To support the performance characteristics, Briton Specification hardware has the following features:

- Back to back fixing bolts and threaded bushes on lever furniture provide a strong through fixing.
- Spindle is fixed to the inside and the outside lever handle by "break thru" grub screws providing greater security and durability.
- All lever handles achieve EN 1906 Grade 4, the highest grade of use within the standard\*.
- Grub screw fixings on levers concealed from view on the underside.
- Slimline roses only 4mm thick.
- Precision engineered levers are prefixed to the rose or plate inner by hi-tensile circlip.
- Unique 'ClickFit' system provides a positive snap fit for pressed rose and escutcheon covers.
- Torx head fixings supplied with all leversets and plate mounted levers provide a high quality look and minimise tampering.
- Comprehensively tested to EN 1634 for use in timber fire doors up to 90 minutes and steel doors up to 4 hours (see fire test certificate for further details).
- All stainless steel construction Grade 304 with Grade 3 corrosion resistance to EN 1670.

\* Grade 4 category of use is defined as suitable for high frequency use on doors which are subject to frequent violent use, e.g football stadiums, oil rigs, barracks, public toilets.



applicable  
products only





Ref:	<b>4701.20.140</b>
Type:	Return to door, round bar lever Mounted on 52mm dia. concealed fix roses with bolt through fixings
Dimensions:	Ø20 x 140mm
Certification:	EN 1906 Grade 4 EN 1670 Grade 3 EN 1634 Up to 90 minutes (timber) EN 1634 Up to 4 hour (steel)
Other:	Approved for use with escape locks to EN 179 for emergency exit applications Supplied as a pair with 8mm spindle and bolt through fixings for 44 - 54mm doors*

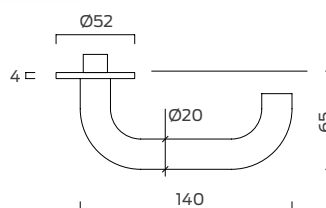

\* Alternative fixing pack for 55 - 65mm doors (4701.55-65.FS)



# Classically contemporary style



Ref:	<b>4701.20.175</b>
Type:	Extended return to door, round bar lever Mounted on 52mm dia. concealed fix roses with bolt through fixings
Dimensions:	Ø20 x 175mm
Certification:	EN 1906 Grade 4 EN 1670 Grade 3 EN 1634 Up to 90 minutes (timber) EN 1634 Up to 4 hr (steel)
Other:	Approved for use with escape locks to EN 179 for emergency exit applications Supplied as a pair with 8mm spindle and bolt through fixings for 44 - 54mm doors*

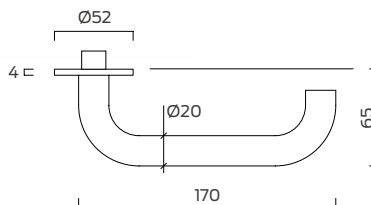

\* Alternative fixing pack for 55 - 65mm doors (4701.55-65.FS)



Ref:	<b>4701.22.140</b>
Type:	Return to door, round bar lever Mounted on 52mm dia. concealed fix roses with bolt through fixings
Dimensions:	Ø22 x 140mm
Certification:	EN 1906 Grade 4 EN 1670 Grade 3 EN 1634 Up to 90 minutes (timber) EN 1634 Up to 4 hr (steel)
Other:	Approved for use with escape locks to EN 179 for emergency exit applications Supplied as a pair with 8mm spindle and bolt through fixings for 44 - 54mm doors*

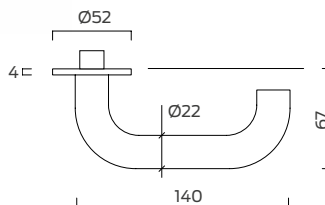

\* Alternative fixing pack for 55 - 65mm doors (4701.55-65.FS)



## Briton 4700 Series door furniture - Lever handles



Ref:	<b>4703.20.140</b>
Type:	Straight, round bar lever Mounted on 52mm dia. concealed fix roses with bolt through fixings
Dimensions:	Ø20 x 140mm
Certification:	EN 1906 Grade 4
	EN 1670 Grade 3
	EN 1634 Up to 90 minutes (timber) EN 1634 Up to 4 hr (steel)
Other:	Supplied as a pair with 8mm spindle and bolt through fixings for 44 - 54mm doors*

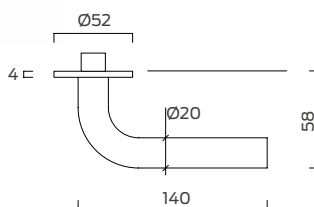

\* Alternative fixing pack for 55 - 65mm doors (4701.55-65.FS)



## Briton 4700 Series door furniture - Lever handles



Ref:	<b>4704</b>
Type:	Straight mitred round bar lever Mounted on 52mm dia. concealed fix roses with bolt through fixings
Dimensions:	Ø20 x 140mm
Certification:	EN 1906 Grade 4 EN 1670 Grade 3 EN 1634 Up to 90 minutes (timber) EN 1634 Up to 4 hr (steel)
Other:	Supplied as a pair with 8mm spindle and bolt through fixings for 44 - 54mm doors*

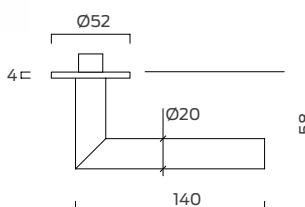

\* Alternative fixing pack for 55 - 65mm doors (4701.55-65.FS)



Ref:	<b>4705.20.140</b>
Type:	Curved mitred round bar lever Mounted on 52mm dia. concealed fix roses with bolt through fixings
Dimensions:	Ø20 x 135mm
Certification:	EN 1906 Grade 4 EN 1670 Grade 3 EN 1634 Up to 90 minutes (timber) EN 1634 Up to 4 hr (steel)
Other:	Supplied as a pair with 8mm spindle and bolt through fixings for 44 - 54mm doors*

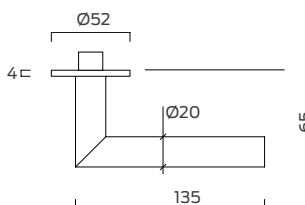

\* Alternative fixing pack for 55 - 65mm doors (4701.55-65.FS)



Briton 4700 Series door furniture - Lever handles



Ref:	4706
Type:	Wing design formed lever Mounted on 52mm dia. concealed fix roses with bolt through fixings
Dimensions:	63 x 130mm
Certification:	EN 1906 Grade 4
	EN 1670 Grade 3
	EN 1634 Up to 90 minutes (timber) EN 1634 Up to 4 hr (steel)
Other:	Supplied as a pair with 8mm spindle and bolt through fixings for 44 - 54mm doors*

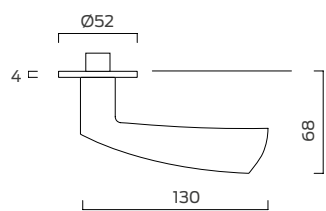

\* Alternative fixing pack for 55 - 65mm doors (4701.55-65.FS)



## Briton 4700 Series door furniture - Lever handles



Ref:	<b>4707</b>
Type:	Hollow cut away flat lever Mounted on 52mm dia. concealed fix roses with bolt through fixings
Dimensions:	56.5 x 135
Certification:	EN 1906 Grade 4 EN 1670 Grade 3 EN 1634 Up to 90 minutes (timber) EN 1634 Up to 4 hr (steel)
Other:	Supplied as a pair with 8mm spindle and bolt through fixings for 44 - 54mm doors*

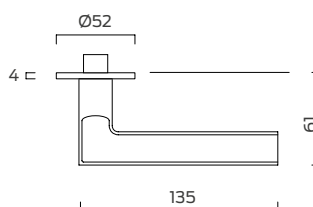

\* Alternative fixing pack for 55 - 65mm doors (4701.55-65.FS)



Ref:	<b>4708</b>
Type:	Hollow curve form lever Mounted on 50mm dia. concealed fix roses with bolt through fixings
Dimensions:	60 x 122
Certification:	EN 1906 Grade 4 EN 1670 Grade 3 EN 1634 Up to 90 minutes (timber) EN 1634 Up to 4 hr (steel)
Other:	Supplied as a pair with 8mm spindle and bolt through fixings for 44 - 54mm doors*

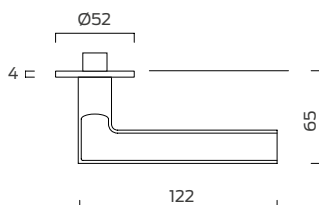

\* Alternative fixing pack for 55 - 65mm doors (4701.55-65.FS)



Briton 4700 Series door furniture - Lever handle accessories



Ref:	4713.4	4714.4	4715.4
Description:	Euro profile cylinder escutcheon	Lever key escutcheon	Blank escutcheon
Dimensions:	Ø52 x 4mm	Ø52 x 4mm	Ø52 x 4mm
Other:	Concealed fixings with snap on cover. Supplied as pairs as standard. Bolt through fixings supplied as standard suitable for doors 44mm-54mm		



Ref:	4710	4711
Description:	Bathroom turn & indicator	Bathroom extended turn & indicator
Dimensions:	Ø52 x 4mm	Ø52 x 4mm
Other:	Supplied with 8mm spindle. Bolt through fixings supplied as standard suitable for doors 44mm-54mm	



Briton 4700 Series door furniture - Lever handles



Ref:	<b>4702BP.B.22.140</b>	<b>4702BP.EC.22.140</b>
Description:	Plate mounted lever handle Ø22 Blank plate for use with latches	Plate mounted lever handle Ø22 Backplate with cutout for euro profile cylinders for use with sashlocks
Dimensions:	170 x 170 x 2mm	170 x 170 x 2mm
Certification:	EN 1906 Grade 4 & EN 1670 Grade 3. Included in fire tests to EN 1634 (see fire test reports for further information)	
Other:	Supplied as a pair with bolt through fixings and 8mm spindle suitable for doors 44 - 54mm *	

\* Alternative fixing pack for 55 - 65mm doors (4701.55-65.FS)



Ref:	<b>4702BP.WC</b>
Description:	Plate mounted lever handle Ø22 Backplate with bathroom function turn and indicator
Dimensions:	170 x 170 x 2mm
Certification:	EN 1906 Grade 4 & EN 1670 Grade 3. Included in fire tests to EN 1634 (see fire test reports for further information)
Other:	Supplied as a pair with bolt through fixings and 8mm spindle suitable for doors 44 - 54mm* Plate assemblies are handed - see below

\* Alternative fixing pack for 55 - 65mm doors (4701.55-65.FS)

Backplate handing



Left hand  
4702BP.WC.22.140.SS.L

Right hand  
4702BP.WC.22.140.SS.R

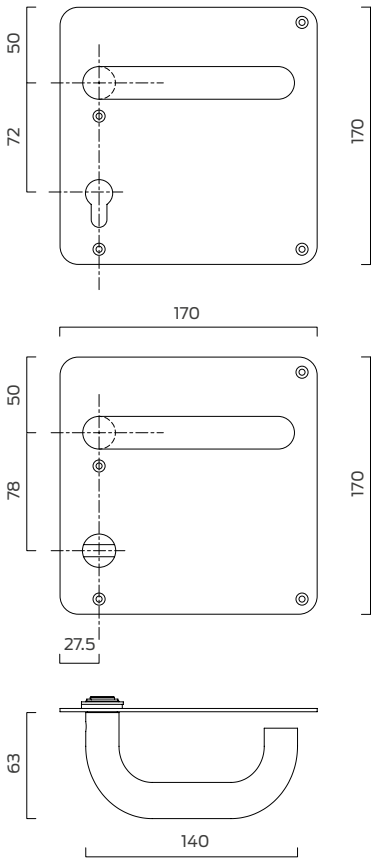

Briton 4700 Series door furniture - Pull handles

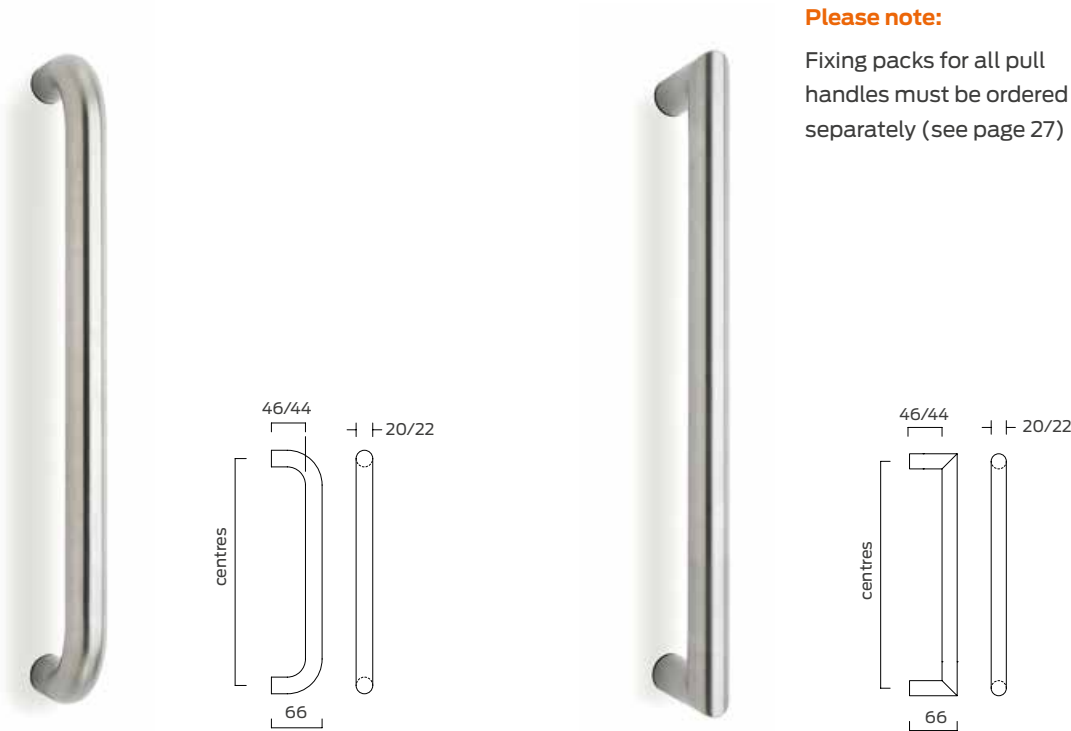

**Please note:**  
Fixing packs for all pull handles must be ordered separately (see page 27)

Description:	D pull handle - Round bar section							
Ref:	4721.20.200	4721.22.200	4721.20.300	4721.22.300	4721.20.400	4721.22.400	4721.20.600	4721.22.600
Diameter: mm	20	22	20	22	20	22	20	22
Centres:	200		300		400		600	

Description:	Mitred handle - Round bar section							
Ref:	4722.20.200	4722.22.200	4722.20.300	4722.22.300	4722.20.400	4722.22.400	4722.20.600	4722.22.600
Diameter: mm	20	22	20	22	20	22	20	22
Centres:	200		300		400		600	





## Briton 4700 Series door furniture - Pull handles

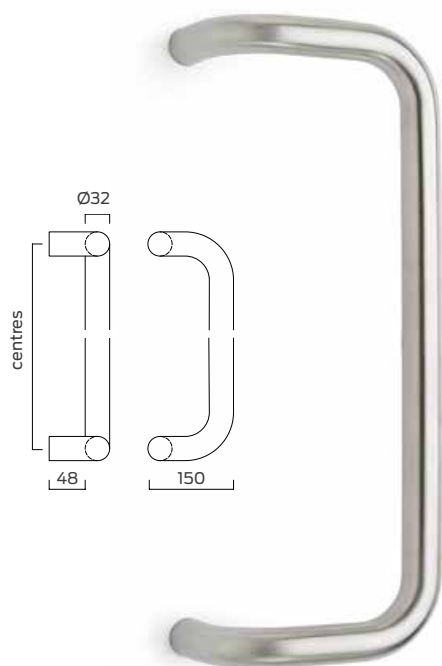

Description:	Cranked pull handle - Round bar section	
Ref:	<b>4723.32.400</b>	<b>4723.32.600</b>
Diameter: mm	32	32
Centres:	400	600



### Please note:

Fixing packs for all pull handles must be ordered separately (see page 27)

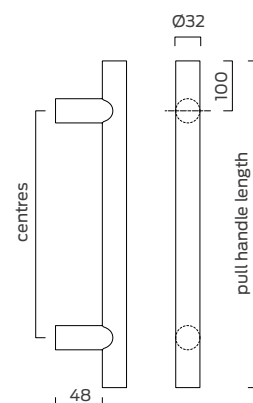

Description:	Pillar pull handle - Round bar section	
Ref:	<b>4724.32.400</b>	<b>4724.32.600</b>
Diameter: mm	32	32
Centres:	200	400



Briton 4700 Series door furniture - Pull handle fixings

Pull handle fixings

All Briton 4700 Series pull handles can be ordered individually and must be ordered together with a standard fixing pack which contains all the components required to mount the pull handle in any of the 4 applications shown below.

For back to back assembly simply order 2 individual pull handles plus the standard fixing pack.

Bolt through - single pull handle

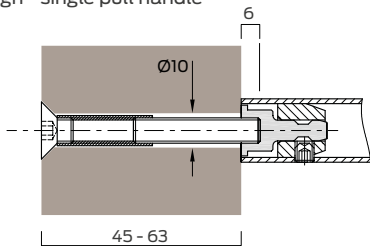

Secret fix - single pull handle

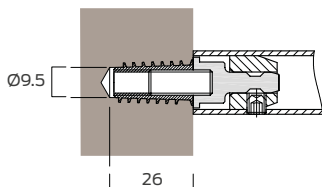

Back to back pair on timber door

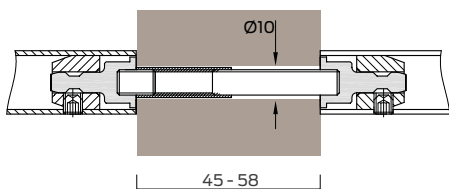

Back to back pair on glass door

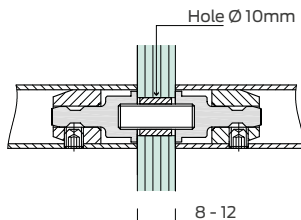

Ref:	Description
4726	Standard fixing pack for timber, metal or glass doors



Rose mount fixings

Briton 4721 and 4722 pull handles can be ordered with an optional face fixed rose. One fixing pack is required for each pull handle and they must be ordered according to the pull handle diameter (20 or 22mm).

Roses are supplied with stainless steel face fixing screws. Snap fit push on covers conceal all fixings.

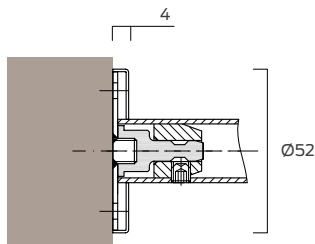

Ref:	Description
4725.20	Face fixed rose mounting kit for 20mm diameter pull handles.
4725.22	Face fixed rose mounting kit for 22mm diameter pull handles.



**For optimum performance**

The 4700 Series furniture range offers specifiers a wide choice of styles for the primary operating hardware - lever handles and pull handles - which are ideally matched with the Briton ranges of high performance lockcases, Briton and CISA Euro profile cylinders for optimum performance.

# A range of accessories completes the integrated door hardware package



## Accessories

The Briton door furniture range includes a selection of additional components required to complete a doorset specification. All accessory components are manufactured in satin stainless steel to match the principal items.

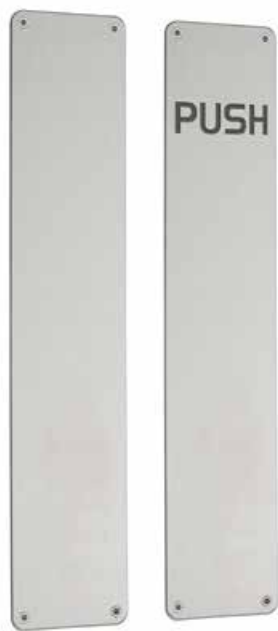

**Kick plates**

Kick plates are available in Grade 304 stainless steel in heights and widths to order. Plates have square corners as standard but are also available with radiused corners (5mmR or 10mmR).

Supplied with face fixings as standard (self adhesive option also available).

Other options and materials are available - please ask for details.

Plates are priced per square metre.

Description:	Push and Pull plates for use with bolt through pull handles	
Options:	Plain or engraved. Radiused corners with face fixing screws. Supplied singly.	
4730.75.375	75mm x 375mm	Plain
4730.75.475	75mm x 475mm	Plain
4730.75.675	75mm x 675mm	Plain
4731.75.375	75mm x 375mm	Engraved 'PUSH'
4731.75.475	75mm x 475mm	Engraved 'PUSH'
4731.75.675	75mm x 675mm	Engraved 'PUSH'
4732.75.375	75mm x 375mm	Engraved 'PULL'
4732.75.475	75mm x 475mm	Engraved 'PULL'
4732.75.675	75mm x 675mm	Engraved 'PULL'

Ref:	Description
4760.304	Kick plate 1.2mm thick. Satin stainless steel Grade 304. Square corners with face fixing screws.
4761.304	Kick plate 1.5mm thick. Satin stainless steel Grade 304. Square corners with face fixing screws.

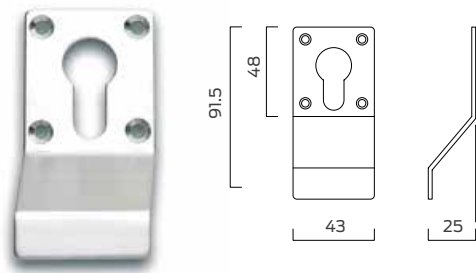

Ref:	Description
4733	Cylinder pull with aperture for euro profile cylinder. Supplied with stainless steel face fixings.



## Briton 4700 Series door furniture - Accessories

### Symbols & signage

A range of 76mm dia. face fixed stainless steel signs and symbols are available.



Description:	Signs & symbols
Options:	A range of face fixed signs and symbols. All 76mm Ø x 1.5mm stainless steel. Supplied singly complete with wood screw fixings.
Ref:	Description
<b>4750.01</b>	Unisex symbol
<b>4750.02</b>	Male symbol
<b>4750.03</b>	Female symbol
<b>4750.04</b>	Disabled symbol
<b>4750.05</b>	WC sign
<b>4750.06</b>	Shower symbol
<b>4750.07</b>	Baby Change symbol
<b>4750.08</b>	Push
<b>4750.09</b>	Pull
<b>4750.10</b>	Fire door keep shut
<b>4750.11</b>	Fire door keep locked
<b>4750.12</b>	Automatic fire door keep clear



## Briton 4700 Series door furniture - Accessories

### Flush bolts

Used to secure the inactive leaf of an equal or unequal pair of doors. The Briton Specification series includes a range of stainless steel lever action flush bolts. Available square or radius ended and in various lengths to suit door height.

Tested to EN 12051:1999 and Graded **43 - 0131**

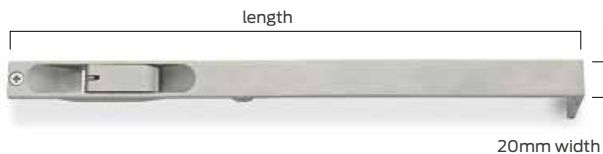

Description:	Flush bolts	
Options:	In a range of lengths and with square or radiused ends. Supplied singly with stainless steel fixings.	
Ref:	Size	End Type
<b>4735.R.20.202</b>	202mm x 20mm	Radiused
<b>4735.R.20.300</b>	300mm x 20mm	Radiused
<b>4735.R.20.450</b>	450mm x 20mm	Radiused
<b>4735.R.20.600</b>	600mm x 20mm	Radiused
<b>4735.R.20.914</b>	914mm x 20mm	Radiused
<b>4735.S.20.202</b>	202mm x 20mm	Square
<b>4735.S.20.300</b>	300mm x 20mm	Square
<b>4735.S.20.450</b>	450mm x 20mm	Square
<b>4735.S.20.600</b>	600mm x 20mm	Square
<b>4735.S.20.914</b>	914mm x 20mm	Square



Description:	Flush bolts - Fully enclosed	
Options:	With square or radiused ends. Supplied singly.	

Ref:	Size	End Type
<b>4739.R.18.225</b>	225mm x 18mm	Radiused
<b>4739.S.18.225</b>	225mm x 18mm	Square



Ref:	Description
<b>4736</b>	Plunger type dust excluding floor socket for use with flush bolts - concealed fixing
<b>4737</b>	Easy clean floor socket for use with flush bolts - face fixing.



Ref:	Description
<b>FB41P</b>	Automatic flush bolt - Bolt is actuated by the closing action of the door. Meets ANSI A156.3 Type 25. Supplied as a pair. Fully automatic - inactive door is latched, bolts are extended when active door closes. Bolts retract when active door is opened. Low activation forces - top bolt has no spring tension.

Briton 4700 Series door furniture - Accessories



Ref:	4740	4741	4742	4743
Description:	Domed floor mounted door stop	Floor mounted door stop	Wedge shaped floor mounted door stop	Wall or skirting mounted door stop
Dimensions:	Ø45 x 24mm	Ø40 x 38mm	Ø46 x 26mm	Ø50 x 90mm
Other:	Supplied with stainless steel fixings			

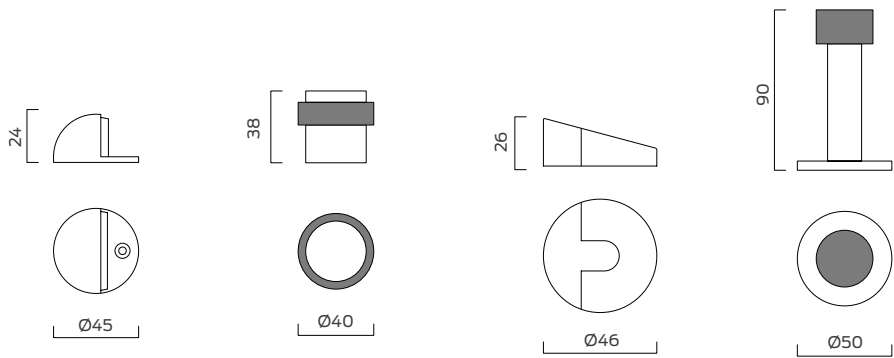

Ref:	Description
482	Security door guard in cast steel



Ref:	Description
U696	Door viewer - small For door thicknesses 35 - 52mm Maximum viewing angle 150°
U698	Door viewer - large For door thicknesses 35 - 54mm Maximum viewing angle 180°

## Briton 4700 Series door furniture - Accessories

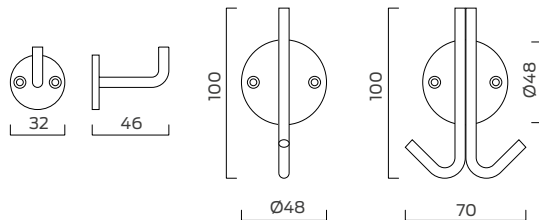

Ref:	Description
<b>4744</b>	Single hook - small, face fixed
<b>4745.1</b>	Single hook - large, face fixed
<b>4745.2</b>	Double hook - large, face fixed
All hooks supplied with stainless steel face fixings	



## Normbau nylon hardware

Normbau 0440 steel cored pull handles in black with 0471 44 back to back fixing for glass doors.





# Colour co-ordinated hardware in solid nylon

Normbau solid nylon hardware is in constant use in public and commercial buildings throughout the world and has a proven track record of durability and performance. Normbau nylon is coloured throughout and will not fade or chip making it an ideal choice for areas of heavy usage such as schools, hospitals and leisure centres.



# Tough, hygienic and warm to the touch

## Standards and performance

Normbau nylon lever and pull handles are inherently warm to the touch which makes the Normbau range an ideal solution for applications which must satisfy the requirements of BS 8300 for disabled access. The choice of colour can be done for aesthetic or practical reasons in order to maximise colour contrast with the door face to assist users with impaired vision.

Normbau products have been approved by PSA to MOB H3PS high duty performance standards and lever sets conform to EN 1906:1999

Critical products in the Normbau range have either been included in fire tests or have been assessed to BS 476 Part 22:1987. For further information on fire certification please contact the Allegion Customer Care Team.

Normbau nylon products are precision manufactured from high strength polyamide nylon that is:

- Scratch resistant
- Hygienic
- Cadmium free
- Anti-static
- Highly resistant to weather, fading and ageing

All products are available as standard in 10 distinctive colours. Other colours to match corporate environments can be achieved at additional cost.

For the purpose of colour co-ordination with other building elements we have provided the nearest RAL-DS colour reference.

They are also resistant to conventional domestic cleaners, disinfectants, dilute acids and alkalis.

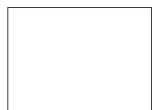

White 19 - NWH  
RAL-DS 000 95 00



Manhattan 67 - NMG  
RAL-DS 080 70 05



Dk Grey 18 - NDG  
RAL-DS 000 35 00



Black 16 - NBL  
RAL-DS 000 15 00



Slate Blue 63 - NSB  
RAL-DS 240 50 15



Blue 11 - NBU  
RAL-DS 270 30 40



Dk Blue 37 - NDB  
RAL-DS 270 20 25



Green 13 - NGR  
RAL-DS 160 30 38



Red 12 - NRE  
RAL-DS 030 30 45



Yellow 22 - NYE  
RAL-DS 080 80 90

Due to print limitations, we recommend you to check colours against actual samples available from Allegion.



Normbau levers are available in solid nylon or with a steel core for additional strength.

They are available in a variety of rose or plate mounted options. All variants feature:

- Bolt through fixings at lever and escutcheon positions to suit Briton mortice lock cases.
- Concealed fixings with snap on rose/plate covers.
- Supplied complete with all fixings and appropriate spindles for specified door thickness.

Normbau leversets are available in three mounting and construction options. The fittings are not interchangeable and must be ordered as complete assemblies.

### Ball bearing mounting

Levers are supplied with backplates or roses which incorporate a ball bearing race which retains the lever for a quick and maintenance free assembly.

One lever is supplied with a floating spindle.

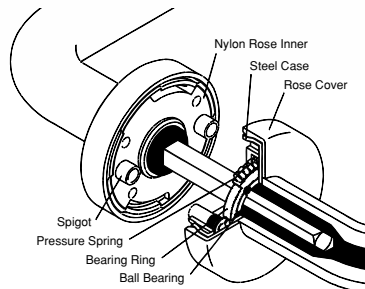

### Fixed roses and backplates

Levers are supplied pre-assembled to the rose or plate inner with a friction washer and circlip fixing ensuring a durable performance.

One lever is supplied with a floating spindle.

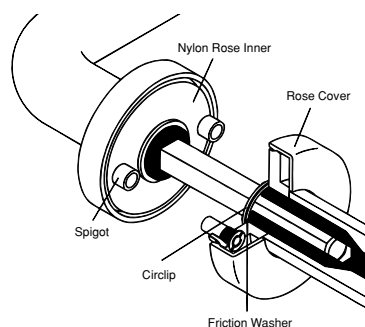

### Spindle fixed

Levers are supplied with loose roses or backplates.

One lever is supplied with a floating spindle with threaded section. The opposite lever contains a cup point socket grub screw which positively engages with the threaded spindle to firmly connect the levers together.

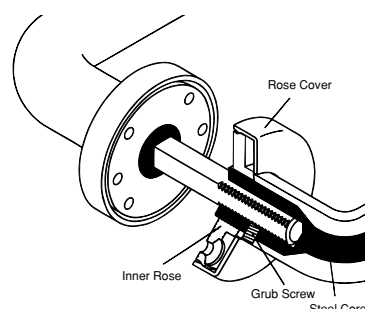

Normbau nylon hardware - Ball bearing leversets



Ball bearing mounting

For rose mounted versions please specify the rose and appropriate escutcheon required for the lock type being used.

For plate mounted versions specify the plate according to the lock type being used.

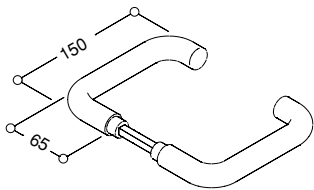

Ref:	<b>23mm Ø - Steel cored</b>
<b>0389 01</b>	pair c/w spindle -
<b>0389 41</b>	1/2 set c/w 1/2 spindle
<b>0389 03</b>	1/2 set without spindle

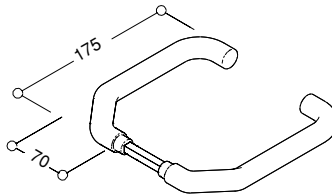

Ref:	<b>23mm Ø - Steel cored</b>
<b>0388 01</b>	pair c/w spindle -
<b>0388 41</b>	1/2 set c/w 1/2 spindle
<b>0388 03</b>	1/2 set without spindle

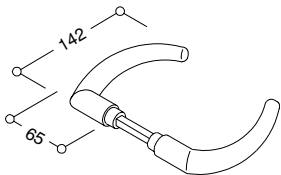

Ref:	<b>23mm Ø - Coupe lever steel cored</b>
<b>0282 01</b>	pair c/w spindle -
<b>0282 41</b>	1/2 set c/w 1/2 spindle
<b>0282 03</b>	1/2 set without spindle

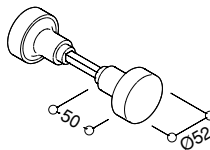

Ref:	<b>52mm Ø - Knob</b>
<b>0387 01</b>	pair c/w spindle -
-	
<b>0387 05</b>	1/2 set without spindle

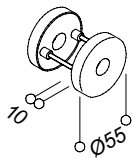

Ref:	<b>Ball bearing rose</b>
<b>0390 03</b>	Pair - suitable for all levers and knob

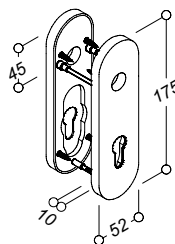

Ref:	<b>Ball bearing plate</b>
<b>0405 05</b>	Latch only
<b>0405 02</b>	Euro profile cylinder @ 72mm c-c
<b>0405 03**</b>	Bathroom function @ 78mm c-c

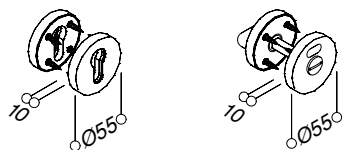

Ref:	<b>Escutcheons</b>
<b>0396 26</b>	Blind -
<b>0396 29</b>	Lever key escutcheon for lever locks
<b>0396 30</b>	Euro profile cylinder - any centres
<b>0397 40**</b>	Bathroom function - any centres

\*\* Bathroom functions supplied with 8mm spindle

## Normbau nylon hardware - Fixed roses and backplates



### Fixed roses and backplates

Levers are supplied pre-fixed to the rose or plate inner. Cover plates are snap fit to conceal all fixings.

Rose mounted versions may require the use of escutcheons to suit the lock case being used.

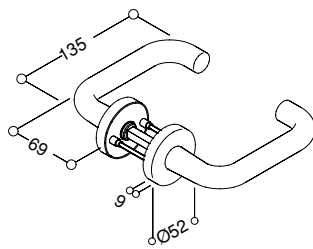

Ref:	<b>20mm Ø - Steel cored</b>
<b>0516 01</b>	pair c/w spindle -

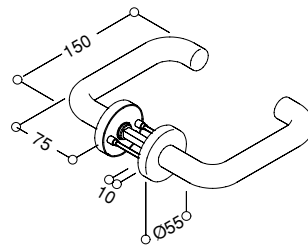

Ref:	<b>23mm Ø - Steel cored</b>
<b>0516 03</b>	pair c/w spindle -

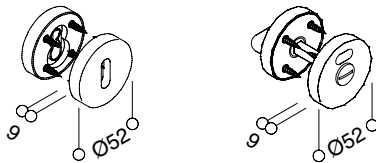

Ref:	<b>Escutcheons 52mm Ø</b>
<b>0247 26</b>	Blind escutcheon
<b>0247 31</b>	Lever key escutcheon
<b>0247 32</b>	Euro profile cylinder escutcheon
<b>0247 90</b>	Oval profile cylinder escutcheon
<b>0358 34*</b>	Bathroom turn and indicator
<b>0840 44**</b>	Bathroom turn - large, and indicator

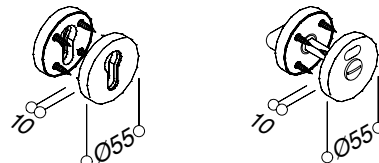

Ref:	<b>Escutcheons 55mm Ø</b>
<b>0396 26</b>	Blind escutcheon
<b>0396 31</b>	Lever key escutcheon
<b>0396 32</b>	Euro profile cylinder escutcheon
<b>0396 47</b>	Oval profile cylinder escutcheon
<b>0397 40**</b>	Bathroom turn and indicator

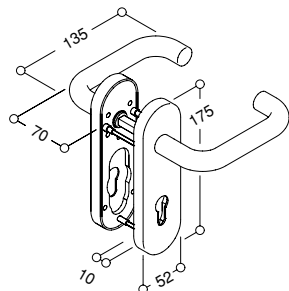

Ref:	<b>20mm Ø lever - Plate mounted</b>
<b>0623 20</b>	Latch only
<b>0623 73</b>	Lever key @ 57mm c-c
<b>0623 74</b>	Euro profile cylinder @ 57mm c-c
<b>0623 17</b>	Euro profile cylinder @ 72mm c-c
<b>0623 75</b>	Oval profile cylinder @ 57mm c-c
<b>0623 76</b>	Oval profile cylinder @ 72mm c-c
<b>0623 77*</b>	Bathroom function @ 57mm c-c
<b>0623 18**</b>	Bathroom function @ 78mm c-c

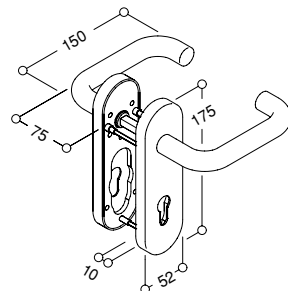

Ref:	<b>23mm Ø lever - Plate mounted</b>
<b>0434 20</b>	Latch only
<b>0434 73</b>	Lever key @ 57mm c-c
<b>0434 74</b>	Euro profile cylinder @ 57mm c-c
<b>0434 17</b>	Euro profile cylinder @ 72mm c-c
<b>0434 75</b>	Oval profile cylinder @ 57mm c-c
<b>0434 76</b>	Oval profile cylinder @ 72mm c-c
<b>0434 77*</b>	Bathroom function @ 57mm c-c
<b>0434 18**</b>	Bathroom function @ 78mm c-c

\* Bathroom functions supplied with 5mm spindle    \*\* Bathroom functions supplied with 8mm spindle



## Normbau nylon hardware - Spindle fixed levers

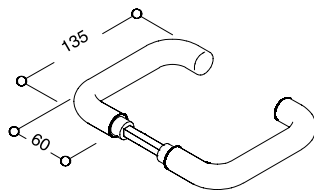

Ref:	20mm Ø lever
<b>0246 08</b>	Solid nylon
<b>0570 15</b>	Steel cored - for doors 23-37mm thick
<b>0570 08</b>	Steel cored - for doors 38-52mm thick
<b>0570 14</b>	Steel cored - for doors 53-63mm thick

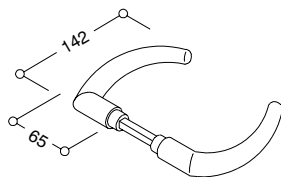

Ref:	23mm Ø Coupe lever
<b>0577 01</b>	Steel cored - for doors 23-37mm thick
<b>0577 02</b>	Steel cored - for doors 38-52mm thick
<b>0577 03</b>	Steel cored - for doors 53-63mm thick

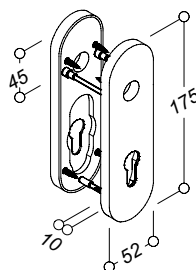

Ref:	Backplates for spindle fixed levers
<b>0525 10</b>	Latch only
<b>0525 08</b>	Lever key @ 57mm c-c
<b>0525 09</b>	Euro profile cylinder @ 57mm c-c
<b>0523 22</b>	Euro profile cylinder @ 72mm c-c
<b>0525 13</b>	Oval profile cylinder @ 48.5mm c-c
<b>0525 14</b>	Oval profile cylinder @ 56mm c-c
<b>0525 12</b>	Oval profile cylinder @ 57mm c-c
<b>0525 11*</b>	Bathroom function @ 57mm c-c
<b>0524 28**</b>	Bathroom function @ 78mm c-c

### Spindle fixed levers

Levers and roses or backplate are supplied separately.

Roses are available with springing to suit lightly sprung latches.

Levers are available in solid nylon or steel cored for extra strength and fire door applications. Steel cored levers must be ordered to suit the door thickness.

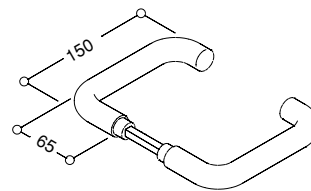

Ref:	23mm Ø lever
<b>0246 18</b>	Solid nylon
<b>0571 15</b>	Steel cored - for doors 23-37mm thick
<b>0571 08</b>	Steel cored - for doors 38-52mm thick
<b>0571 14</b>	Steel cored - for doors 53-63mm thick

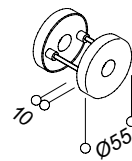

Ref:	Roses for spindle fixed levers
<b>0247 10</b>	Rose 52mm Ø
<b>0247 39</b>	Sprung inner to suit 52mm Ø rose
<b>0396 02</b>	Rose 55mm Ø

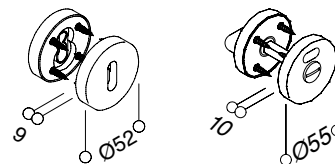

Ref:	Escutcheons 52 & 55mm Ø
<b>0247 26</b>	52mm Ø - Blind
<b>0247 31</b>	52mm Ø - Lever key
<b>0247 32</b>	52mm Ø - Euro profile cylinder
<b>0247 90</b>	52mm Ø - Oval profile cylinder
<b>0358 34*</b>	52mm Ø - Bathroom function
<b>0840 44**</b>	52mm Ø - Bathroom function, large turn
<b>0396 26</b>	55mm Ø - Blind
<b>0396 29</b>	55mm Ø - Lever key
<b>0396 30</b>	55mm Ø - Euro profile cylinder
<b>0396 47</b>	55mm Ø - Oval profile cylinder
<b>0397 40**</b>	55mm Ø - Bathroom function

\* Bathroom functions supplied with 5mm spindle \*\* Bathroom functions supplied with 8mm spindle

**Normbau nylon hardware - Pull handles**

The in-built strength of Normbau pull handles provides both durable fixing and lasting aesthetics. Available in either solid nylon or with a steel core for added strength, the pulls can be fitted singly or back to back in pairs using a variety of fixing types.

Each Normbau pull handle design is available as a 'thread side' or 'pin side' pull handle and should be specified according to the required fixing type. For example, a back to back pair requires one 'thread side' and one 'pin side' pull together with fixing pack 0471.

[Note: the smaller 23mm Ø pulls are the only exception and are supplied as dedicated single bolt through, back to back or face fixed assemblies].

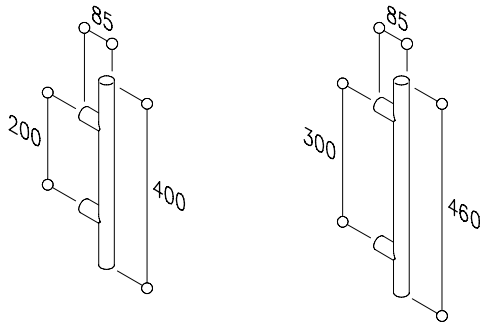

Ref:	34mm Ø solid nylon
<b>0441 01</b>	200mm c-c - Thread side pull handle
<b>0441 11</b>	200mm c-c - Pin side pull handle
<b>0445 01</b>	300mm c-c - Thread side pull handle
<b>0445 11</b>	300mm c-c - Pin side pull handle

Normbau nylon hardware - Pull handles

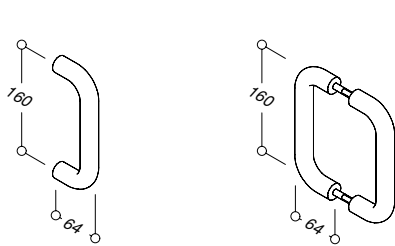

Ref:	<b>23mm Ø solid nylon</b>
<b>0309 17</b>	Single bolt through fixing - supplied without screw fixings
<b>0309 19</b>	Back to back pair
<b>0309 20</b>	Single face fixing on 55mm Ø roses

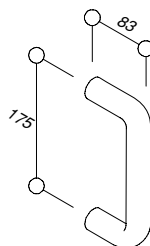

Ref:	<b>31mm Ø solid nylon</b>
<b>0363 04</b>	Thread side pull handle
<b>0363 14</b>	Pin side pull handle

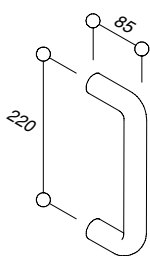

Ref:	<b>34mm Ø solid nylon</b>
<b>0363 01</b>	Thread side pull handle
<b>0363 11</b>	Pin side pull handle

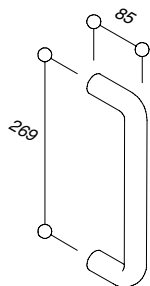

Ref:	<b>34mm Ø solid nylon</b>
<b>0364 01</b>	Thread side pull handle
<b>0364 11</b>	Pin side pull handle

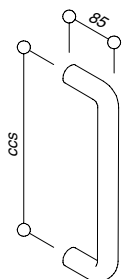

	<b>34mm Ø steel cored</b>				
	200mm centres	300mm centres	400mm centres	500mm centres	600mm centres
Thread side pull	<b>0439 01</b>	<b>0444 01</b>	<b>0363 19</b>	<b>0363 18</b>	<b>0363 17</b>
Pin side pull	<b>0439 11</b>	<b>0444 06</b>	<b>0363 29</b>	<b>0363 28</b>	<b>0363 27</b>

Please Note:

Check whether a 'thread side' or 'pin side' pull handle is required according to the required fixing type. A back to back pair requires one 'thread side' and one 'pin side' pull. See page 30 for more information.

## Normbau nylon hardware - Pull handles

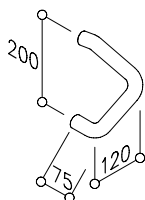

Ref:	<b>34mm Ø solid nylon</b>
<b>0440 09</b>	Thread side pull handle
<b>0440 39</b>	Pin side pull handle

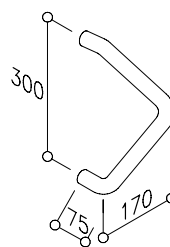

Ref:	<b>34mm Ø solid nylon</b>
<b>0440 11</b>	Thread side pull handle
<b>0440 41</b>	Pin side pull handle

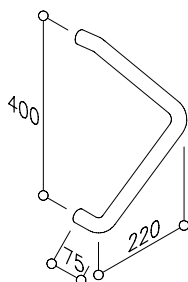

Ref:	<b>34mm Ø solid nylon</b>
<b>0440 13</b>	Thread side pull handle
<b>0440 43</b>	Pin side pull handle

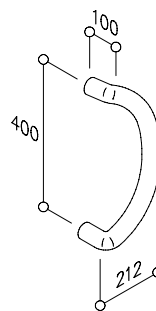

Ref:	<b>40mm Ø steel cored</b>
<b>0440 10</b>	Thread side pull handle
<b>0440 40</b>	Pin side pull handle

Normbau nylon hardware - Pull handles

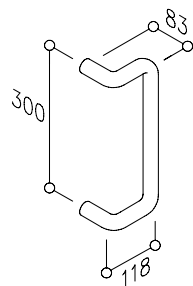

Ref:	<b>31mm Ø solid nylon</b>
<b>0443 12</b>	Thread side pull handle
<b>0443 22</b>	Pin side pull handle

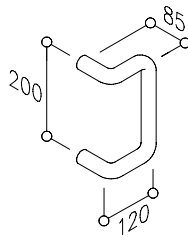

Ref:	<b>34mm Ø solid nylon</b>
<b>0438 02</b>	Thread side pull handle
<b>0438 12</b>	Pin side pull handle

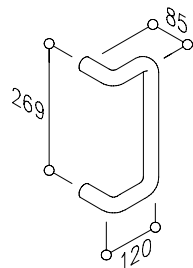

Ref:	<b>34mm Ø solid nylon</b>
<b>0303 06</b>	Thread side pull handle
<b>0303 16</b>	Pin side pull handle

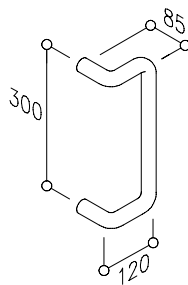

Ref:	<b>34mm Ø solid nylon</b>
<b>0443 02</b>	Thread side pull handle
<b>0443 32</b>	Pin side pull handle

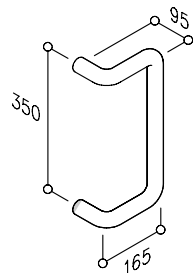

Ref:	<b>40mm Ø solid nylon</b>
<b>0303 07</b>	Thread side pull handle
<b>0303 17</b>	Pin side pull handle

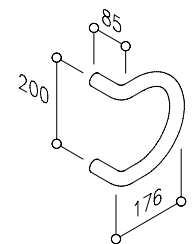

Ref:	<b>34mm Ø solid nylon</b>
<b>0440 01</b>	Thread side pull handle
<b>0440 31</b>	Pin side pull handle

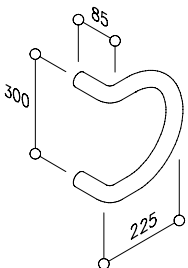

Ref:	<b>34mm Ø steel cored</b>
<b>0440 06</b>	Thread side pull handle
<b>0440 36</b>	Pin side pull handle

## Normbau nylon hardware - Pull handles

### Pull handle fixings

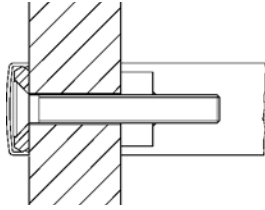

Ref:	Bolt through fixing with screw cover cap
<b>0365 12</b>	For 31mm Ø pull handles
<b>0365 12</b>	For 34mm Ø pull handles
<b>0365 22</b>	For 40mm Ø pull handles
<b>0365 37</b>	Bolt only
	For use with 'thread side' pulls only

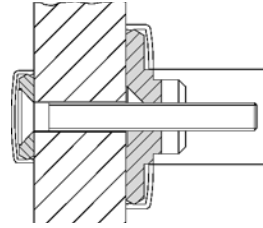

Ref:	Bolt through fixing with screw cover cap and rose
<b>0381 170</b>	For 31mm Ø pull handles - roses 70mm Ø
<b>0365 170</b>	For 34mm Ø pull handles - roses 70mm Ø
<b>0365 270</b>	For 40mm Ø pull handles - roses 80mm Ø
	For use with 'thread side' pulls only

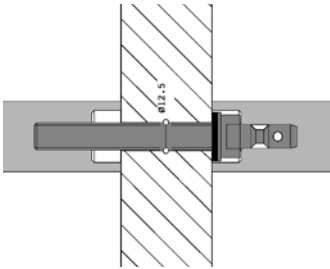

Ref:	Back to back fixing on timber
<b>0471 11</b>	For door thickness 38 - 48mm
<b>0471 12</b>	For door thickness 48 - 58mm
	Use with 'thread side' and 'pin side' pulls

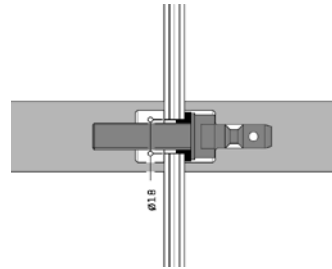

Ref:	Back to back fixing on glass
<b>0471 44</b>	For glass thickness 8 - 18mm
	Hole dia. in glass 12mm
	Use with 'thread side' and 'pin side' pulls

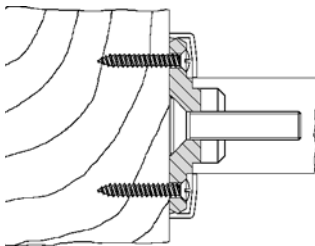

Ref:	Face fixing with covered roses
<b>0381 19</b>	For pull handles 31mm Ø - roses 70mm Ø
<b>0365 19</b>	For pull handles 34mm Ø - roses 70mm Ø
<b>0365 29</b>	For pull handles 40mm Ø - roses 80mm Ø
	For use with 'thread side' pulls only

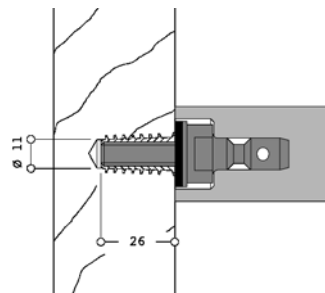

Ref:	Blind fixing on timber
<b>0471 32</b>	For all pull handles 31mm Ø - 40Ø
	For use with 'pin side' pulls only



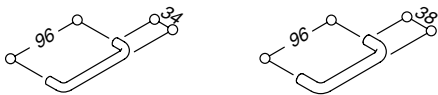

Ref:	Cabinet pulls
0503 01	10mm Ø x 96 x 34 - without screws
0307 21	12mm Ø x 96 x 38 - without screws
0307 22	12mm Ø x 96 x 38 - with 4mm screws

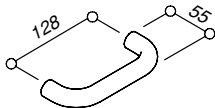

Ref:	Cabinet pulls
0309 01	20mm Ø x 128 x 55 - without screws

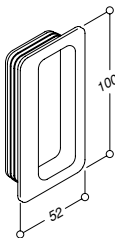

Ref:	Flush pull
0342 01	Flush pull 100 x 52mm

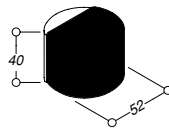

Ref:	Door stop
0842 01	Floor mounted with soft buffer

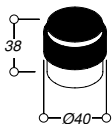

Ref:	Door stop
0842 03	Floor mounted with soft buffer

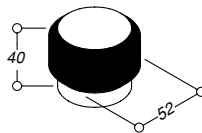

Ref:	Door stop
0346 01	Floor mounted with soft buffer

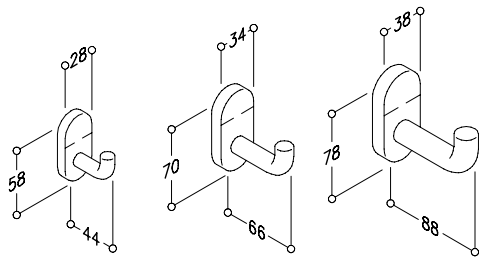
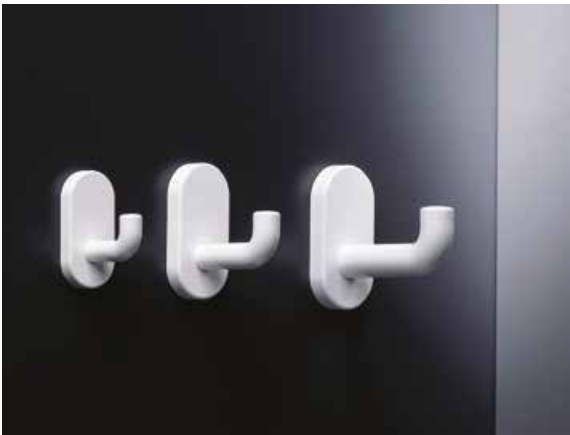

Ref:	Coat hook
0583 10	Coat hook - 44mm projection
0583 11	Coat hook - 66mm projection
0583 12	Coat hook - 88mm projection

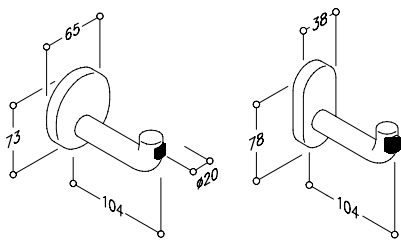

Ref:	Coat hook with buffer
0340 01	Coat hook with buffer - circular plate
0583 15	Coat hook with buffer - oblong plate

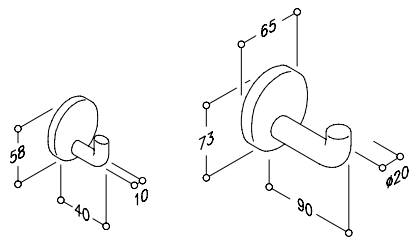

Ref:	Coat hook
0305 01	Coat hook - 10mm Ø
0339 01	Coat hook - 20mm Ø

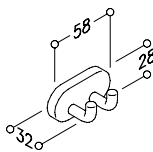

Ref:	Double coat hook
0583 20	Coat hook - 10mm Ø

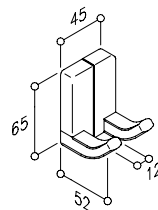

Ref:	Double coat hook
0584 05	Double coat hook

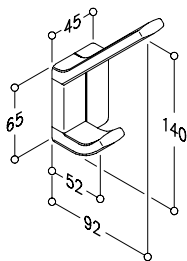

Ref:	Coat hook
0584 01	Hat & coat hook

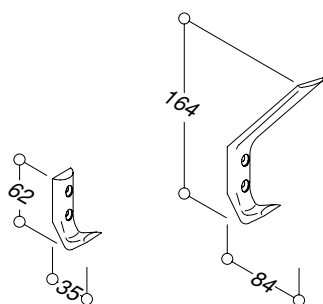

Ref:	Coat hook
<b>0160 01</b>	Coat hook 62 x 35mm
<b>0160 02</b>	Hat & coat hook 164 x 84mm

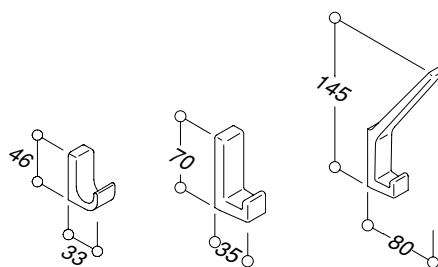

Ref:	Coat hook
<b>0522 01</b>	Coat hook 46 x 33mm
<b>0180 04</b>	Coat hook 70 x 35mm
<b>0180 05</b>	Hat & coat hook 145 x 80mm



Ref:	Numerals
<b>0611 01</b>	Figure 1 - 180mm high
<b>0611 02</b>	Figure 2 - 180mm high
<b>0611 03</b>	Figure 3 - 180mm high
<b>0611 04</b>	Figure 4 - 180mm high
<b>0611 05</b>	Figure 5 - 180mm high
<b>0611 06</b>	Figure 6 & 9 - 180mm high
<b>0611 07</b>	Figure 7 - 180mm high
<b>0611 08</b>	Figure 8 - 180mm high
<b>0611 00</b>	Figure 0 - 180mm high
<b>0611 09</b>	Letter a - 123mm high
<b>0611 10</b>	Letter b - 174mm high
<b>0611 11</b>	Letter c - 123mm high
<b>0611 12</b>	Letter d - 174mm high
<b>0611 19</b>	Dash (-) - 27mm high



Ref:	Symbols
<b>0510 01</b>	Male - 130mm high
<b>0510 02</b>	Female - 130mm high
<b>0510 04</b>	Disabled - 130mm high

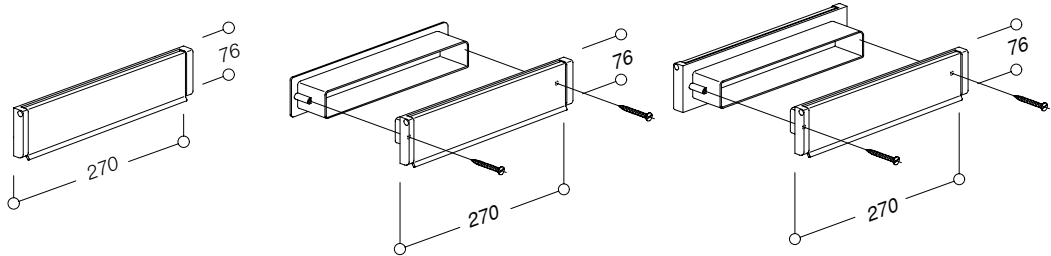

	Sprung letter plate only	Sprung letter plate & liner	Sprung letter plate, liner & inside tidy
Aperture size	230 x 35mm	254 x 45mm	254 x 45mm
Colours 16 & 19	0621 21	0621 23	0621 25
Other colours	0021 21	0021 23	0021 25

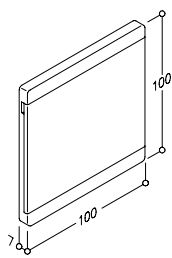

Ref:	Card frame
0846 01	Card frame with clear insert

## Briton and Normbau trim - Additional door hardware

The Briton and Normbau door hardware shown in this brochure form just part of a complete doorset specification. A wide range of additional components are available to complete each doorset. Detailed product brochures are available on the following items. Please contact the Customer Care Team on 01922 707400 for further information.

### Lockcases and cylinders

A complete programme of CE marked Euro profile mortice lock cases and cylinders to the latest European standards. Available with a full masterkeying service if required.



Briton 5500 Series lockcases

### Overhead door closers and floor springs

All carrying the renowned Briton brand, a large range of CE marked overhead door controls and floor springs suitable for all types of application from simple budget closers through to electromagnetic hold-open cam action closers. Available in finishes to match Briton and Normbau door hardware for a fully integrated doorset.



Briton 2300 Series cam action closers

### Panic and emergency exit hardware

From high end specification multi-point locking touch bar systems through to low end push bars offering single point latching, the Briton ranges of panic and emergency exit hardware are renowned for quality and reliability.



Briton 560 Series modular panic exit hardware

### Access control

Offering a selection of mechanical or electronic online or offline systems, Allegion manufacturers systems which can be used alongside other Briton hardware products to complete a doorset specification.



eSigno from CISA - proximity access control

Cl/Sfb	(31.59)	X	
Uniclass	L4181		

April 2015

## About Allegion

Allegion (NYSE: ALLE) is a global pioneer in safety and security, with leading brands like CISA®, Interflex®, LCN®, Schlage® and Von Duprin®. Focusing on security around the door and adjacent areas, Allegion produces a range of solutions for homes, businesses, schools and other institutions. Allegion is a \$2 billion company, with products sold in almost 130 countries.

For more, visit [allegion.co.uk](http://allegion.co.uk)



### Allegion (UK) Limited

35 Rocky Lane  
Birmingham  
West Midlands  
B6 5RQ

Tel: +44 (0) 121 3802400

Email: [contactuk@allegion.com](mailto:contactuk@allegion.com)

Web: [allegion.com/uk](http://allegion.com/uk)

### Allegion International AG (Dubai Branch)

17th Floor, U-Bora Towers  
Business Bay  
P.O Box 390641 Dubai  
UAE

Tel: +971 4 818 8999

Email: [mea@allegion.com](mailto:mea@allegion.com)

Web: [allegion.com](http://allegion.com)